

MODEL Z 2670

Standard Run MSRP \$99,630

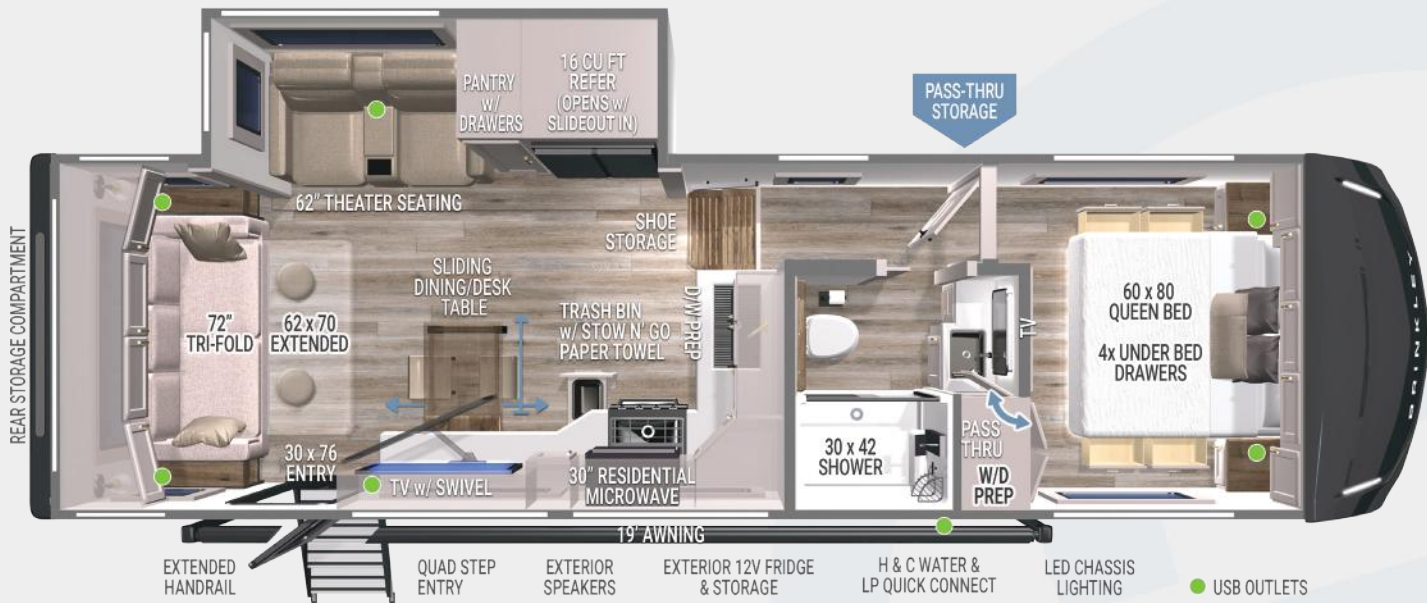

SPECIFICATIONS:

- UVW – 10,291 lbs.
- GVWR – 13,995 lbs.
- Hitch Weight – 1,809 lbs.
- Exterior Length – 29' 11"
- Overall Height w/ AC – 13' 3"
- Width – 96"
- Bath & Bedroom Height - 79 ½"
- Slide Height - 76"
- Axles – Tandem 7,000 lbs.
- Wheels & Tires – 17.5" H-Rated
- Fresh Water Capacity – 75 gal
- Gray Water Capacity – 90 gal (True)
- Black Water Capacity – 45 gal
- Insulation – Floors/Ceiling R40, Walls R11

FEATURES:

- 72" Trifold Sofa (62"x70" Sleeper)
- Sliding Desk/Dining Table w/ Storage Drawer
- 50" Articulating TV
- Solid Surface Countertops
- Dishwasher Prep
- Brinkley CraftSense™ Wood Trim Construction
- Premium Residential Cabinets & Drawers w/ Dovetail Joints
- Kitchen & Living Room Flush Floor Main Slide
- 13.5k Front AC w/ Heat Pump
- Furion 18k Chill® Cube Rear AC
- Large Pantry w/ Pull-Out Drawers
- One-Piece Fiberglass Shower
- Washer/Dryer Prep (Stackable or Combo)
- 4 Under-Bed Storage Drawers
- Rockford Stereo w/ App Control + Subwoofer Prep
- Residential Queen Memory Foam Mattress w/ Nightstands, Outlets & USB & USB-C
- Square Euro Frameless Windows w/ 6" Openings
- Integrated Window Screens & Insulated Blackout Blinds (No Valances)
- Brinkley Automotive-Grade Sealant Package
- Automotive Grade Front Cap, Lights, & Lens
- Sleek Styling w/ Automotive-Grade Exterior Graphics
- 2 - Hot/Cold Outdoor Showers (BOTH sides of coach)
- Tankless On-Demand Water Heater
- Heated Enclosed Underbelly (Circulated)
- Exterior 12V Refrigerator (3.3 cu. ft.)
- One-Touch Automatic 4-Point Leveling System
- Industry First Low Maintenance Roof
- On-Command™ Utility Center w/ Retractable 65' Water Hose
- Heated Tanks w/ Electric Waste Valves w/ Manual-Override
- CURT Touring Coil Suspension System w/ ABS Brakes
- CURT Helux™ King Pin w/ Coil Spring & Shock-Absorber
- 370W Solar Panel w/ 60AMP MPPT Controller (Inverter Prep & Lithium Ready)

FACTORY OPTIONS:

- Dual Pane Windows \$1,731
- Gen-Y® Executive Gooseneck w/ SnapLatch Torsion Flex \$1,876

Optional equipment & props may be shown.
All content is subject to change without notice.
Please consult with your dealer for current information.

LaMESA REC VAN

LaMesaRV.com
800-496-8778

BRINKLEY

For More Information, Photos, Videos
& Why Brinkley go to **BrinkleyRV.com**



033125

MODEL Z 2810

AVAILABLE STARTING IN JUNE
Standard Run MSRP \$107,637

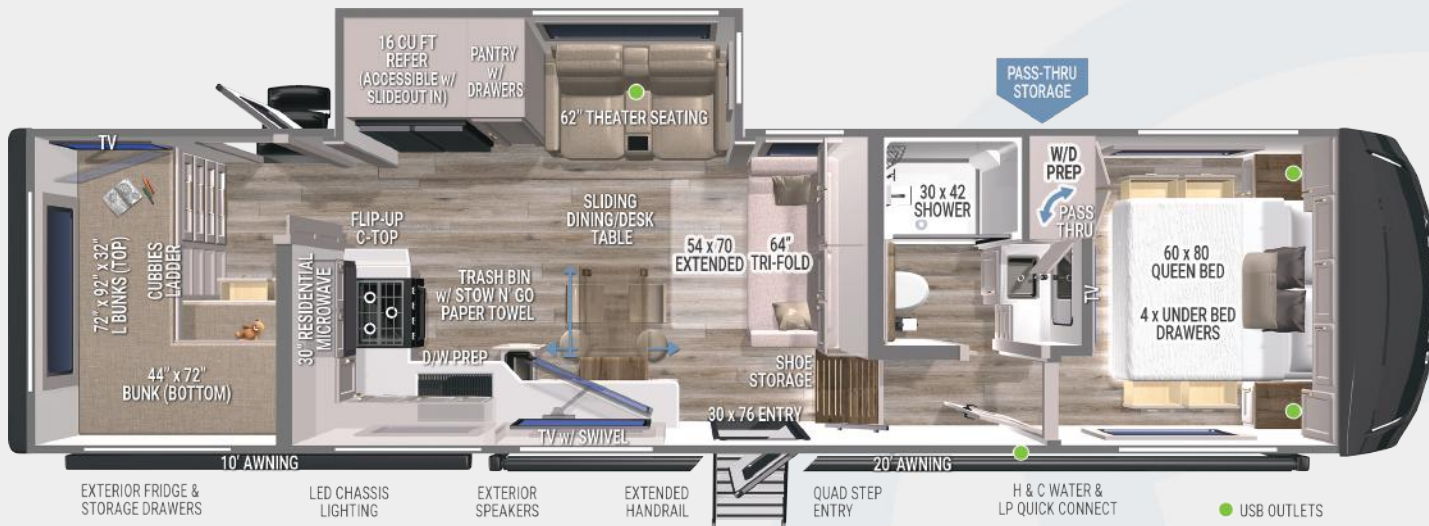

SPECIFICATIONS:

- UVW – 11,834 lbs.
- GVWR – 14,995 lbs.
- Hitch Weight – 1,978 lbs.
- Exterior Length – 34' 9"
- Overall Height w/ AC – 13' 3"
- Width – 96"
- Bath & Bedroom Height - 79 ½"
- Slide Height - 76"
- Axles – Tandem 7,000 lbs.
- Wheels & Tires – 17.5" H-Rated
- Fresh Water Capacity – 75 gal
- Gray Water Capacity – 80 True + 40 gal
- Black Water Capacity – 40 gal
- Insulation – Floors/Ceiling R40, Walls R11

FEATURES:

- Private Bunkroom w/ Large Bottom Bunk, Extra Large L Shaped Top Bunk, & Storage Drawers
- 64" Trifold Sofa (54"x70" Sleeper)
- Sliding Desk/Dining Table w/ Storage Drawer
- 50" Articulating TV
- Rockford Stereo w/ App Control + Subwoofer Prep
- Solid Surface Countertops
- Dishwasher Prep
- Brinkley CraftSense™ Wood Trim Construction
- Premium Residential Cabinets & Drawers w/ Dovetail Joints
- Kitchen & Living Room Flush Floor Main Slide
- Road Mode: Access to Fridge, Bedroom, Bunks & Bathroom w/ Slide In
- 13.5k Front AC
- Furrion 18k Chill® Cube Rear AC
- Large Pantry w/ Pull-Out Drawers
- One-Piece Fiberglass Shower
- Washer/Dryer Prep (Stackable or Combo)
- Residential Queen Memory Foam Mattress w/ Nightstands, Outlets & USB & USB-C
- Square Euro Frameless Windows w/ 6" Openings
- Integrated Window Screens & Insulated Blackout Blinds
- Brinkley Automotive-Grade Sealant Package
- Automotive-Grade Front Cap, Lights, & Lens
- Sleek Styling w/ Automotive-Grade Exterior Graphics
- 2 - Hot/Cold Outdoor Showers (BOTH Sides of Coach)
- Tankless On-Demand Water Heater
- Heated Enclosed Underbelly (Circulated)
- Below I-Beam Storage Compartments
- Exterior Refrigerator & Storage Drawers w/ Work Surface
- One-Touch Automatic 4-Point Leveling System
- On-Command™ Utility Center w/ Retractable 65' Water Hose
- Heated Tanks w/ Electric Waste Valves w/ Manual-Override
- CURT Touring Coil Suspension System w/ ABS Brakes + Anti-Sway + Dynamic Brake Boosters
- CURT Helux™ King Pin w/ Coil Spring & Shock-Absorber
- 370W Solar Panel w/ 60AMP MPPT Controller (Inverter Prep & Lithium Ready)

FACTORY OPTIONS:

- Dual Pane Windows \$1,731
- Gen-Y® Executive Gooseneck w/ SnapLatch Torsion Flex \$1,876

050525



MODEL Z 2900

Standard Run MSRP \$110,277

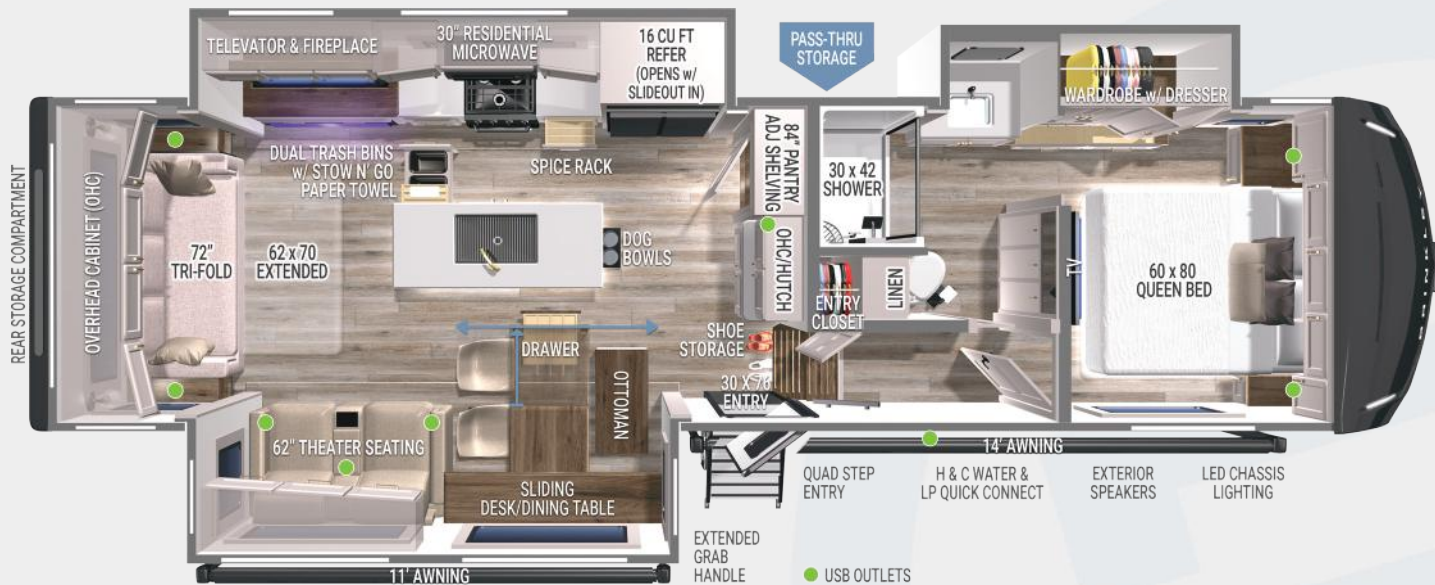

SPECIFICATIONS:

- UVW – 11,674 lbs.
- GVWR – 14,995 lbs.
- Hitch Weight – 2,081 lbs.
- Exterior Length – 32' 11"
- Overall Height w/ AC – 13' 2"
- Width – 96"
- Bath & Bedroom Height - 79 ½"
- Slide Height - 76"
- Axles – Tandem 7,000 lbs.
- Wheels & Tires – 17.5" H-Rated (16 ply)
- Fresh Water Capacity – 75 gal
- Gray Water Capacity – 90 gal (True)
- Black Water Capacity – 45 gal
- Insulation – Floors/Ceiling R40, Walls R11

FEATURES:

- Sliding Desk/Dining Table w/ Extending Leaves & Storage Drawer (Seats up to 4)
- Dual Pull-Out Trash Bins w/ Integrated Stow N' Go Paper Towel Holder
- Brinkley CraftSense™ Wood Trim Construction
- Premium Residential Cabinets & Drawers w/ Dovetail Joints
- 84" Pantry w/ Adjustable Shelves & Appliance Outlet
- Residential End Tables w/ Flip-Up Charging Station & Storage
- Kitchen & Living Room/Dining Room Flush Floor Slides
- Rockford Stereo w/ App Control + Subwoofer Prep
- 18 Outlets & 6 Outlets w/ USB & USB-C
- Pet Feeder w/ Removable Pet Bowls
- Bedside Shelves & Outlets w/ USB & USB-C
- Walkthrough Bathroom
- Square Euro Frameless Windows w/ 6" Openings (Dual Pane Optional)
- Integrated Window Screens & Insulated Blackout Blinds
- Automotive Grade Front Cap, Lights, & Lens
- 370W Solar Panel w/ 60AMP MPPT Controller (Inverter Prep & Lithium Ready)
- 13.5k Front AC w/ Heat Pump
- Furrion 18k Chill® Cube Rear AC
- Basement Utility Access w/ & Motion Lights
- Over 100 Cubic Feet of Exterior Storage w/ Tough Ply Liner
- Rear Storage Compartment (48"x40"x15")

- 2 - Hot/Cold Outdoor Showers (BOTH sides of coach)
- Industry First Brass Plumbing Connections
- Industry First Low Maintenance Roof
- Built-in Wire Conduit from Roof to Basement
- CURT Touring Coil Suspension System w/ ABS Brakes
- CURT Helux™ King Pin w/ Coil Spring & Shock-Absorber
- One-Touch Automatic 4-Point Leveling System
- Electric Waste Valves w/ Indicator Light & Manual-Override

FACTORY OPTIONS:

- Dual Pane Windows \$1,731
- Gen-Y® Executive Gooseneck w/ SnapLatch Torsion Flex \$1,876

120224

Optional equipment & props may be shown.
All content is subject to change without notice.
Please consult with your dealer for current information.

LaMESA REC VAN
LaMesaRV.com
800-496-8778

BRINKLEY

For More Information, MSRP, Photos,
Videos & Why Brinkley go to **BrinkleyRV.com**



MODEL Z 3100

Standard Run MSRP \$112,701



SPECIFICATIONS:

- UVW – 11,923 lbs.
- GVWR – 15,495 lbs.
- Hitch Weight – 2,142 lbs.
- Exterior Length – 34' 11"
- Overall Height w/ AC – 13' 2"
- Width – 96"
- Bath & Bedroom Height - 79 ½"
- Slide Height - 76"
- Axles – Tandem 7,000 lbs.
- Wheels & Tires – 17.5" H-Rated (16 ply)
- Fresh Water Capacity – 75 gal
- Gray Water Capacity – 90 gal (True)
- Black Water Capacity – 45 gal
- Insulation – Floors/Ceiling R40, Walls R11

FEATURES:

- Sliding Desk/Dining Table w/ Extending Leaves & Storage Drawer (Seats up to 4)
- 84" Pantry w/ Adjustable Shelves & Appliance Outlet
- Brinkley CraftSense™ Wood Trim Construction
- Premium Residential Cabinets & Drawers w/ Dovetail Joints
- Kitchen & Living Room/Dining Room Flush Floor Slides
- Residential End Tables w/ Flip-Up Charging Station & Storage
- 20 Outlets & 6 Outlets w/ USB & USB-C
- Pet Feeder w/ Removable Pet Bowls
- Bedside Shelves & Outlets w/ USB & USB-C
- Hidden Sliding Dresser Top Storage Compartment
- Tip-To-Clean Quad Entry Steps

- Rockford Stereo w/ App Control + Subwoofer
- Square Euro Frameless Windows w/ 6" Openings
- Integrated Window Screens & Insulated Blackout Blinds (No Valances)
- Automotive Grade Front Cap, Lights, & Lens
- Sleek & Clean Styling w/ Automotive-Grade Exterior Graphics
- 13.5k Front AC w/ Heat Pump
- Furrion 18k Chill® Cube Rear AC
- Over 130 Cu. Ft. of Exterior Storage w/ Tough Ply Liner
- Rear Storage Compartment (48"x40"x15")
- 2 - Hot/Cold Outdoor Showers (BOTH sides of coach)
- One-Touch Automatic 4-Point Leveling System
- CURT Touring Coil Suspension System w/ ABS Brakes

- CURT Helux™ King Pin w/ Coil Spring & Shock-Absorber
- Built-in Wire Conduit from Roof to Basement
- Industry First Brass Plumbing Connections
- Industry First Low Maintenance Roof
- Basement Utility Access w/ Motion Lights
- Electric Waste Valves w/ Indicator Light & Manual-Override
- 370W Solar Panel w/ 60AMP MPPT Controller (Inverter Prep & Lithium Ready)

FACTORY OPTIONS:

- Queen Bed w/ Nightstands \$428
- Dual Pane Windows \$1,731
- Gen-Y® Executive Gooseneck w/ SnapLatch Torsion Flex \$1,876

Optional equipment & props may be shown.
All content is subject to change without notice.
Please consult with your dealer for current information.

LaMesa REC VAN

LaMesaRV.com
800-496-8778

BRINKLEY

For More Information, MSRP, Photos,
Videos & Why Brinkley go to **BrinkleyRV.com**



120224

MODEL Z 3110

Standard Run MSRP \$112,372

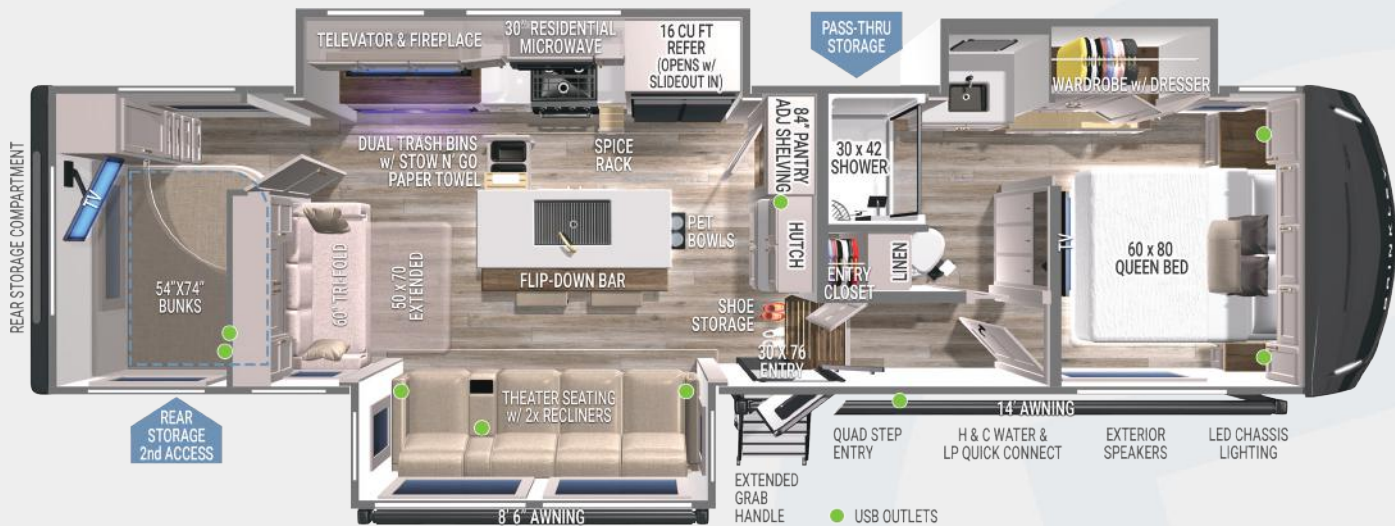

SPECIFICATIONS:

- UVW – 12,146 lbs.
- GVWR – 15,495 lbs.
- Hitch Weight – 2,168 lbs.
- Exterior Length – 34' 11"
- Overall Height w/ AC – 13' 2"
- Width – 96"
- Bath & Bedroom Height - 79 ½"
- Slide Height - 76"
- Axles – Tandem 7,000 lbs.
- Wheels & Tires – 17.5" H-Rated (16 ply)
- Fresh Water Capacity – 75 gal
- Gray Water Capacity – 90 gal (True)
- Black Water Capacity – 45 gal
- Insulation – Floors/Ceiling R40, Walls R11

FEATURES:

- Flip-Down Island Bar w/ Stools
- Brinkley CraftSense™ Wood Trim Construction
- Premium Residential Cabinets & Drawers w/ Dovetail Joints
- Kitchen & Living Room/Dining Room Flush Floor Slides
- 13.5k Front AC w/ Heat Pump
- Furion 18k Chill® Cube Rear AC
- Dual Pull-Out Trash Bins w/ Integrated Stow N' Go Paper Towel Holder
- 84" Pantry w/ Adjustable Shelves & Appliance Outlet
- 20 Outlets & 6 Outlets w/ USB & USB-C
- Built-in Wire Conduit from Roof to Basement
- Pet Feeder w/ Removable Pet Bowls
- Stacked Rear Bunks w/ Double Mattresses (54"x74")
- Bedside Shelves & Outlets w/ USB & USB-C
- Wardrobe Closet w/ Dresser
- Rockford Stereo w/ App Control + Subwoofer Prep
- Square Euro Frameless Windows w/ 6" Openings (Dual Pane Optional)
- Integrated Window Screens & Insulated Blackout Blinds (No Valances)
- Brinkley Automotive-Grade Sealant Package
- Automotive Grade Front Cap, Lights, & Lens
- Sleek & Clean Styling w/ Automotive-Grade Exterior Graphics
- Over 160 Cubic Feet of Exterior Storage w/ Tough Ply Liner
- Large Rear & Campside Accessible Compartment w/ Motion Lighting & Power Outlets

- 2 - Hot/Cold Outdoor Showers (BOTH sides of coach)
- Industry First Low Maintenance Roof
- Basement Utility Access w/ Sliding Doors & Motion Lights
- One-Touch Automatic 4-Point Leveling System
- CURT Touring Coil Suspension System w/ ABS Brakes
- CURT Helux™ King Pin w/ Coil Spring & Shock-Absorber
- Electric Waste Valves w/ Manual-Override
- 370W Solar Panel w/ 60AMP MPPT Controller (Inverter Prep & Lithium Ready)

FACTORY OPTIONS:

- Dual Pane Windows \$1,731
- Gen-Y® Executive Gooseneck w/ SnapLatch Torsion Flex \$1,876

Optional equipment & props may be shown.
All content is subject to change without notice.
Please consult with your dealer for current information.

LaMESA REC VAN
LaMesaRV.com
800-496-8778

BRINKLEY

For More Information, MSRP, Photos,
Videos & Why Brinkley go to **BrinkleyRV.com**



120224

MODEL Z 3300

Standard Run MSRP \$118,957

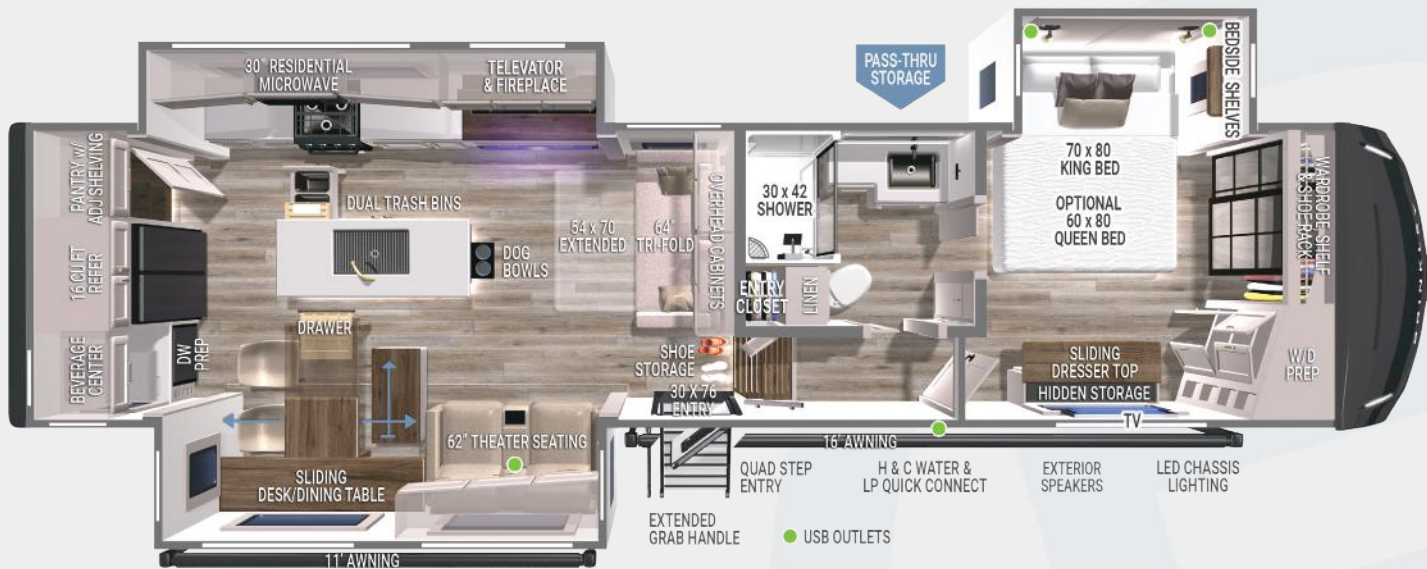

SPECIFICATIONS:

- UVW – 13,127 lbs.
- GVWR – 16,995 lbs.
- Hitch Weight – 2,286 lbs.
- Exterior Length – 36' 7"
- Overall Height w/ AC – 13' 4"
- Width – 96"
- Bath & Bedroom Height - 79 ½"
- Slide Height - 76"
- Axles – Tandem 8,000 lbs.
- Wheels & Tires – 17.5" H-Rated (16 ply)
- Fresh Water Capacity – 150 gal
- Gray Water Capacity – 90 True + 30 gal
- Black Water Capacity – 45 gal
- Insulation – Floors/Ceiling R40, Walls R11

FEATURES:

- Beverage Center w/ Wine Storage, 12V Mini Fridge & 18" x 32" Dish Washer (DW) Prep
- Large Pantry w/ Adjustable Shelves & Appliance Outlet
- Sliding Desk/Dining Table w/ Extending Leaves & Storage Drawer (Seats up to 4)
- Brinkley CraftSense™ Wood Trim Construction
- Premium Residential Cabinets & Drawers w/ Dovetail Joints
- Kitchen & Living Room/Dining Room Flush Floor Slides
- Pet Feeder w/ Removable Pet Bowls
- 64" Trifold Sofa (54"x70" Sleeper)
- Bedside Shelves & Outlets w/ USB & USB-C
- Hidden Sliding Dresser Top Storage Compartment
- Tip-To-Clean Quad Entry Steps
- Square Euro Frameless Windows w/ 6" Openings (Dual Pane Optional)
- Integrated Window Screens & Insulated Blackout Blinds (No Valances)
- Automotive Grade Front Cap, Lights, & Lens
- Sleek & Clean Styling w/ Automotive-Grade Exterior Graphics
- 13.5k Front AC w/ Heat Pump
- Furion 18k Chill® Cube Rear AC
- Rockford Stereo w/ App Control + Subwoofer Prep
- Wide Stance Hydraulic Leveling Jacks & Oversized Front Storage
- Under I-Beam Storage Boxes
- Built-in Wire Conduit from Roof to Basement
- Basement Utility Access w/ Motion Lights

- Industry First Low Maintenance Roof
- Electric Waste Valves w/ Indicator Light & Manual-Override
- 370W Solar Panel w/ 60AMP MPPT Controller (Inverter Prep & Lithium Ready)
- One-Touch Automatic 6-Point Leveling System
- Brinkley Automotive-Grade Sealant Package
- CURT Touring Coil Suspension System w/ ABS Brakes
- CURT Helux™ King Pin w/ Coil Spring & Shock-Absorber

FACTORY OPTIONS:

- Queen Bed w/ Nightstands \$428
- Dual Pane Windows \$1,731
- Gen-Y® Executive Gooseneck w/ SnapLatch Torsion Flex \$1,876

120224

Optional equipment & props may be shown.
All content is subject to change without notice.
Please consult with your dealer for current information.

LaMesa REC VAN
LaMesaRV.com
800-496-8778

BRINKLEY

For More Information, MSRP, Photos,
Videos & Why Brinkley go to **BrinkleyRV.com**



MODEL Z 3400

Standard Run MSRP \$127,916



SPECIFICATIONS:

- UVW – 13,898 lbs.
- GVWR – 17,495 lbs.
- Hitch Weight – 2,391 lbs.
- Exterior Length – 38' 11"
- Overall Height w/ AC – 13'4"
- Width – 96"
- Bath & Bedroom Height - 79 ½"
- Slide Height - 76"
- Axles – Tandem 8,000 lbs.
- Wheels & Tires – 17.5" H-Rated (16 ply)
- Fresh Water Capacity – 75 gal.
- Gray Water Capacity – 90 True + 45 gal.
- Black Water Capacity – 45 gal.
- Insulation – Floors/Ceiling R40, Walls R11

FEATURES:

- Sliding Desk/Dining Table w/ Extending Leaves & Storage Drawer (Seats up to 4)
- Dual Pull-Out Trash Bins w/ Integrated Stow N' Go Paper Towel Holder
- 84" Pantry w/ Adjustable Shelves & Appliance Outlet
- Brinkley CraftSense™ Wood Trim Construction
- Premium Residential Cabinets & Drawers w/ Dovetail Joints
- Kitchen & Living/Dining Room Flush Floor Slides
- Bedside Shelves & Outlets w/ USB & USB-C
- Hidden Sliding Dresser Top Storage Compartment
- 24+ outlets and 6 outlets w/ USB & USB-C
- Pull-Out Storage for 'Stewy' w/ Removable Pet Bowls
- Automotive Grade Front Cap, Lights, & Lens
- Square Euro Frameless Windows w/ 6" Openings (Dual Pane Optional)
- Rockford Stereo w/ App Control + Subwoofer Prep
- Integrated Window Screens & Insulated Blackout Blinds
- 370W Solar Panel w/ 60AMP MPPT Controller (Inverter Prep & Lithium Ready)
- 2 - Hot/Cold Outdoor Showers (BOTH sides of coach)
- Industry First Brass Plumbing Connections
- Large Exterior Storage w/ Tough Ply Liner
- Built-in Wire Conduit from Roof to Basement
- Industry First Low Maintenance Roof
- Electric Waste Valves w/ Indicator Light & Manual-Override
- One-Touch Automatic 6-Point Leveling System
- CURT Touring Coil Suspension System w/ ABS Brakes
- CURT Helux™ King Pin w/ Coil Spring & Shock-Absorber
- 13.5k Front AC w/ Heat Pump
- Furrion 18k Chill® Cube Rear AC

Outdoor Kitchen & Patio Highlights:

- Cabinet Storage, Work Surface, & Bar Sink
- Large 4.5 Cu.Ft. Refrigerator
- 50" Smart TV on Swivel Mount
- Zero-Gravity Rear Patio w/ Electric Top Latches
- Residential Style Wire Patio Railing, Power Awning w/ LED Lighting, & Steps
- Two-Sided MOLLE Panel w/ Prep Table & Cup Holders
- Patio Door w/ Tinted Glass
- EZ-Load Rear Cargo Access Door

FACTORY OPTIONS:

- Queen Bed w/ Nightstands \$428
- Dual Pane Windows \$1,731
- Gen-Y® Executive Gooseneck w/ SnapLatch Torsion Flex \$1,876

Optional equipment & props may be shown.
All content is subject to change without notice.
Please consult with your dealer for current information.

LaMESA REC VAN
LaMesaRV.com
800-496-8778

BRINKLEY

For More Information, MSRP, Photos,
Videos & Why Brinkley go to **BrinkleyRV.com**



022125

MODEL Z 3515

Standard Run MSRP \$124,520

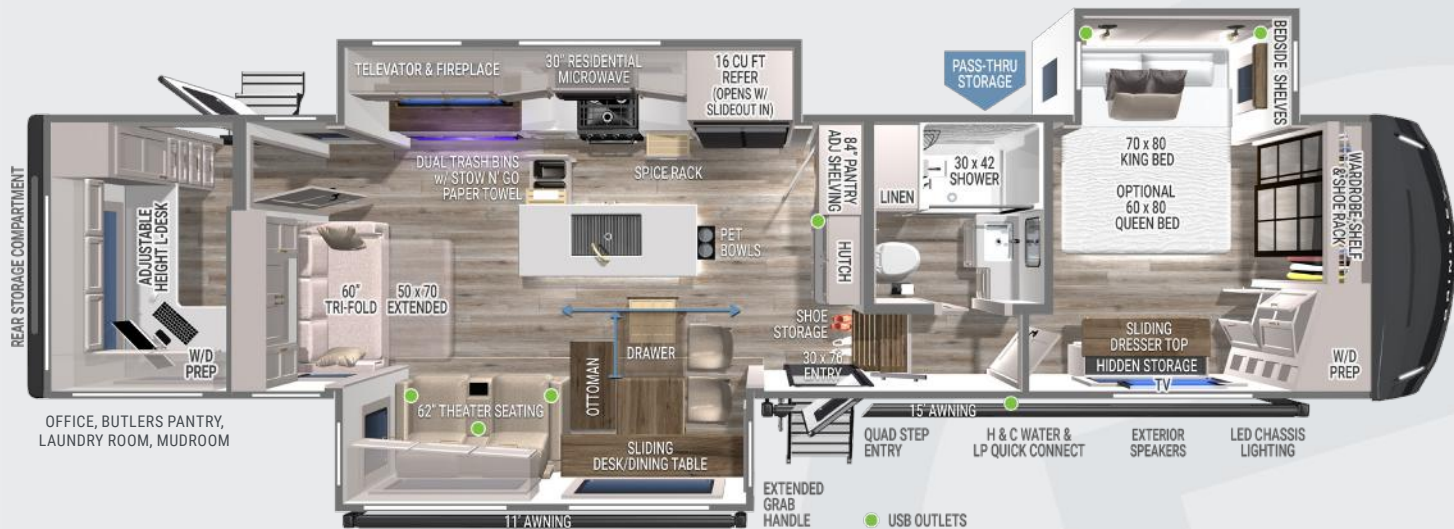

FEATURES:

- Sliding Desk/Dining Table w/ Extending Leaves & Storage Drawer (Seats up to 4)
- 84" Pantry w/ Adjustable Shelves & Appliance Outlet
- Brinkley CraftSense™ Wood Trim Construction
- Premium Residential Cabinets & Drawers w/ Dovetail Joints
- Kitchen & Living Room/Dining Room Flush Floor Slides
- Pet Feeder w/ Removable Bowls
- Bedside Shelves & Outlets w/ USB & USB-C
- Hidden Sliding Dresser Top Storage Compartment
- Tip-To-Clean Quad Entry Steps
- Square Euro Frameless Windows w/ 6" Openings
- Integrated Window Screens & Insulated Blackout Blinds (No Valances)
- Automotive Grade Front Cap, Lights, & Lens
- Industry First Brass Plumbing Connections

- Sleek & Clean Styling w/ Automotive-Grade Exterior Graphics
- 13.5k Front AC w/ Heat Pump
- Furrion 18k Chill® Cube Rear AC
- 2 - Hot/Cold Outdoor Showers (BOTH sides of coach)
- Wide Stance Hydraulic Leveling Jacks & Oversized Front Storage
- Built-in Wire Conduit from Roof to Basement
- Industry First Low Maintenance Roof
- Basement Utility Access w/ Motion Lights
- Electric Waste Valves w/ Indicator Light & Manual-Override
- Rockford Stereo w/ App Control + Subwoofer Prep
- CURT Touring Coil Suspension System w/ ABS Brakes
- CURT Helux™ King Pin w/ Coil Spring & Shock-Absorber
- 370W Solar Panel w/ 60 AMP MPPT Controller (Inverter Prep & Lithium Ready)

SPECIFICATIONS:

- UVW – 13,838 lbs.
- GVWR – 17,495 lbs.
- Hitch Weight – 2,525 lbs.
- Exterior Length – 39' 11"
- Overall Height w/ AC – 13' 4"
- Width – 96"
- Bath & Bedroom Height - 79 ½"
- Slide Height - 76"
- Axles – Tandem 8,000 lbs.
- Wheels & Tires – 17.5" H-Rated (16 ply)
- Fresh Water Capacity – 75 gal
- Gray Water Capacity – 90 True + 30 gal
- Black Water Capacity – 45 gal
- Insulation – Floors/Ceiling R40, Walls R11

Multipurpose Flex Space Highlights:

- Electric Adjustable Height Solid Surface Countertop/Desk w/ 6 Outlets
- 60"x70" of Usable Floor Space Under Countertop
- Overhead Cabinets & Floor to Ceiling Cabinet w/ Drawers
- Dual Washer/Dryer Prep (Combo/Side-by-side in Flex Space, Stackable/Combo in Bedroom)
- Off-Camp Side Second Entry Door

FACTORY OPTIONS:

- Queen Bed w/ Nightstands \$428
- Dual Pane Windows \$1,731
- Gen-Y® Executive Gooseneck w/ SnapLatch Torsion Flex \$1,876

Optional equipment & props may be shown.
All content is subject to change without notice.
Please consult with your dealer for current information.

LaMesa REC VAN
LaMesaRV.com
800-496-8778

BRINKLEY

For More Information, MSRP, Photos,
Videos & Why Brinkley go to **BrinkleyRV.com**



021925

MODEL Z 3610

Standard Run MSRP \$129,291



SPECIFICATIONS:

- UVW – 14,695
- GVWR – 17,695
- Hitch Weight – 2,591
- Exterior Length – 41' 9"
- Overall Height w/ AC – 13' 4"
- Width – 96"
- Bath & Bedroom Height - 79 ½"
- Slide Height - 76"
- Axles – Tandem 8,000 lbs.
- Wheels & Tires – 17.5" H-Rated (16 ply)
- Fresh Water Capacity – 75 gal
- Gray Water Capacity – 90 gal (True)
- Black Water Capacity – 45 gal
- Insulation – Floors/Ceiling R40, Walls R11

FEATURES:

- Sliding Desk/Dining Table w/ Extending Leaves & Storage Drawer (Seats up to 4)
- Pet Feeder w/ Removable Pet Bowls
- Kitchen & Living Room/Dining Room Flush Floor Slides
- 84" Pantry w/ Adjustable Shelves & Appliance Outlet
- Brinkley CraftSense™ Wood Trim Construction
- Premium Residential Cabinets & Drawers w/ Dovetail Joints
- Residential End Tables w/ Flip-Up Charging & Storage
- Bedside Shelves & Outlets w/ USB & USB-C
- Hidden Sliding Dresser Top Storage Compartment
- 24+ outlets and 6 outlets w/ USB & USB-C
- Square Euro Frameless Windows w/ 6" Openings (Dual Pane Optional)
- Integrated Window Screens & Insulated Blackout Blinds (No Valances)
- Industry First Brass Plumbing Connections
- Automotive Grade Front Cap, Lights, & Lens
- Basement Utility Access w/ Motion Lights
- 2 - Hot/Cold Outdoor Showers (BOTH sides of coach)
- Large Exterior Storage Compartments w/ Tough Ply Liner
- Rear Storage Compartment (48"x40"x15")
- Built-in Wire Conduit from Roof to Basement
- Industry First Low Maintenance Roof
- Rockford Stereo w/ App Control + Subwoofer Prep
- CURT Helux™ King Pin w/ Coil Spring & Shock-Absorber
- CURT Touring Coil Suspension System w/ ABS Brakes
- Electric Waste Valves w/ Indicator Light & Manual-Override
- Wide Stance 6-Point Hydraulic Leveling Jacks & Oversized Front Storage
- 370W Solar Panel w/ 60AMP MPPT Controller (Inverter Prep & Lithium Ready)

- 13.5k Front AC & 13.5k Bonus Room AC w/ Heat Pumps + Furrion 18k Chill® Cube Rear AC
- Exterior Refrigerator & Storage Drawers w/ Work Surface

Bonus Room Highlights:

- Sofa Bed (48"x72")
- Trundle Bed (32"x72")
- Overhead Flip Bunk (32"x72")
- Dresser w/ 50" Smart TV & Pull-Out Desk (27"x41.5")

FACTORY OPTIONS:

- Queen Bed w/ Nightstands \$428
- Dual Pane Windows \$1,731
- 72" Trifold Sofa (62"x70" Sleeper w/ Reclining Back) \$428
- Gen-Y® Executive Gooseneck w/ SnapLatch Torsion Flex \$1,876

120224

Optional equipment & props may be shown.
All content is subject to change without notice.
Please consult with your dealer for current information.

LaMESA REC VAN
LaMesaRV.com
800-496-8778

BRINKLEY

For More Information, MSRP, Photos,
Videos & Why Brinkley go to **BrinkleyRV.com**

